

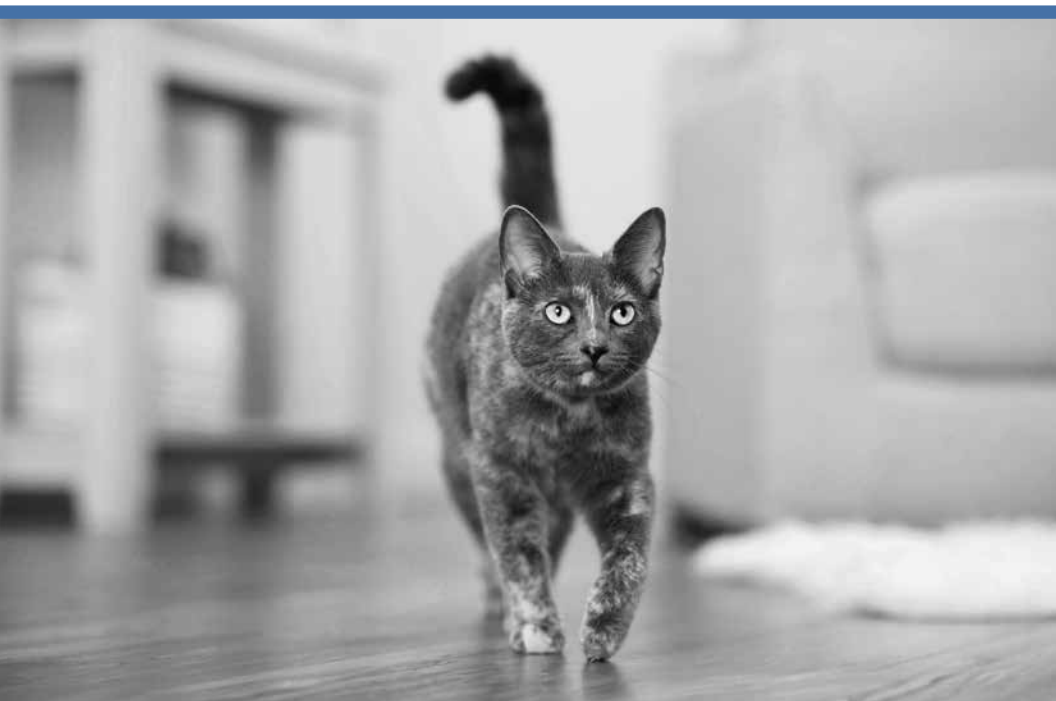

Get Started!



Welcome!

PetSafe® brand is devoted to making sure you and your pet have what you need to live your best life together. We know that safe pets make happy people. Before getting started, please take a moment to read through this important safety information. If you have any questions, please don't hesitate to contact us.

Hereinafter Radio Systems Corporation and any other affiliate or Brand of Radio Systems Corporation may be referred to collectively as "We" or "Us".

IMPORTANT SAFETY INFORMATION

Explanation of attention words and symbols used in this guide



This is the safety alert symbol. It is used to alert you to potential personal injury hazards. Obey all safety messages that follow this symbol to avoid possible injury or death.

⚠ WARNING

WARNING indicates a hazardous situation which, if not avoided, could result in death or serious injury.

⚠ CAUTION

CAUTION, used with the safety alert symbol, indicates a hazardous situation which, if not avoided, could result in minor or moderate injury.

CAUTION

CAUTION, used without the safety alert symbol, indicates a hazardous situation which, if not avoided, could result in harm to your pet.

NOTICE

NOTICE is used to address practices not related to personal injury.

⚠ WARNING

Not for use with aggressive pets. Do not use this product if your pet is aggressive or is prone to aggressive behavior. Aggressive pets can cause severe injury and even death to their owner and others. If you are unsure whether this product is appropriate for your pet, please consult your veterinarian or a certified trainer.

CONTENTS UNDER PRESSURE.

- Keep out of reach of children.
- Do not puncture. Do not burn.
- Protect from sunlight.
- Store away from heat. Store in a well-ventilated place.

First Aid and Treatment: If you inhale the spray and feel unwell, seek medical attention. After skin contact, rinse the affected area with soap and water. After eye contact, rinse/flush eyes gently using water for 15–20 minutes.

Do not expose this product to freezing temperatures (32°F) or to conditions warmer than 113°F. Do not leave this product in direct sunlight or in a car where it can reach 113°F.

⚠ CAUTION

This product is not a toy. Keep it away from the reach of children. Use it only to deter pets from particular areas.

CAUTION

This product is only for use with healthy pets. If you're not certain that your pet is in good health, we recommend that you take your pet to a veterinarian before using this product.

NOTICE

- Do not mix old and new batteries.
- Do not mix standard, alkaline or rechargeable batteries.
- Do not use rechargeable batteries.
- Exhausted batteries should be removed immediately. Do not dispose of batteries with household waste.

SSSCAT[®]

Automatic Spray Pet Deterrent

We know it can be challenging to keep your pets out of mischief. They wait until you're not watching and then down goes the trash can, or there they are, sitting on the countertop again. Maybe you feel like you need eyes on the back of your head. SSSCAT[®] Automatic Spray Pet Deterrent can be that second set of eyes for you, even when you're not home.

What is it? The SSSCAT[®] Automatic Spray Pet Deterrent consists of a motion-activated spray holder containing a can of unscented spray deterrent. When your pet approaches, the SSSCAT[®] system releases a quick burst of spray, startling your pet. While the spray is safe and odorless, most cats and dogs dislike being sprayed and quickly learn to avoid it. By placing the spray deterrent near an off-limits area (next to a trash can, on your kitchen counter, in the doorway of a "no-pets-allowed" room), you can deter your pet from a variety of unwanted behaviors.

How does it work? The spray deterrent recognizes motion up to 3 feet away using a passive infrared sensor that detects your pet's body heat. Because of this, it may not work properly if you place it too close to a heat source (such as a dishwasher or heating vent), and it may not be able to sense your long-haired pet if she's just been outdoors on a cold day. The motion sensor also detects human body heat; keep this in mind as you choose a location.

What you have:

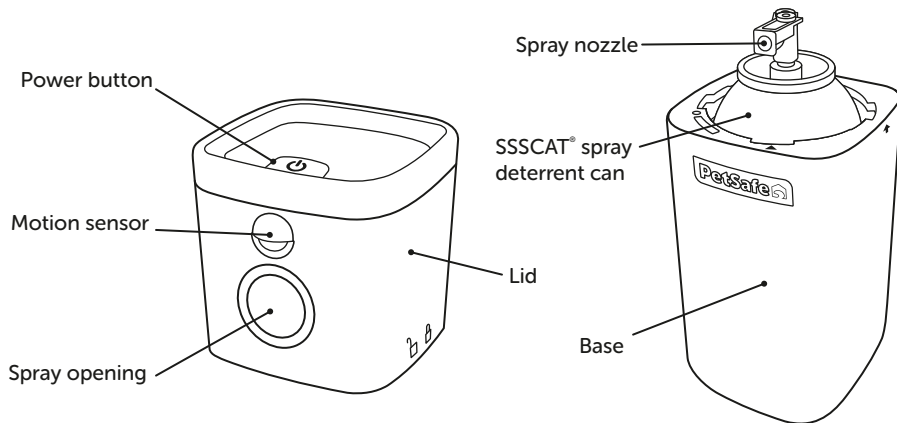

What you need:

4 AAA alkaline batteries (not included)

Let's help your little troublemaker make good.

Set up the spray deterrent

1

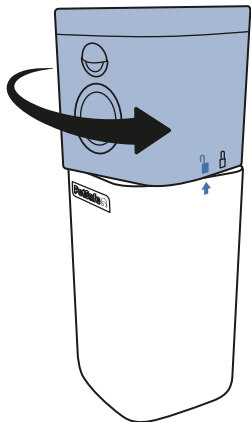

Unlock the lid of the spray deterrent by turning it counterclockwise until the unlock icon on the lid lines up with the arrow on the base.

Remove the lid.

2

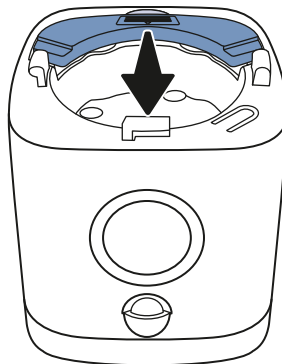

Turn the lid over. Insert your finger into the notch behind the battery cover and pull the battery cover forward to remove it.

3

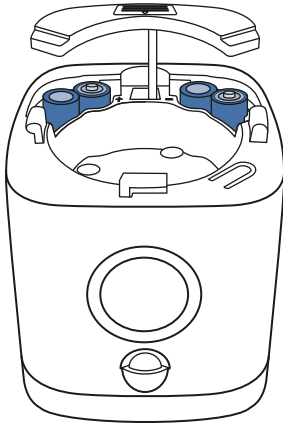

Insert four AAA alkaline batteries (not included).

To replace the battery cover, insert the two tabs at the front of the battery cover under the two clips on the base and then press the battery cover down into position.

4

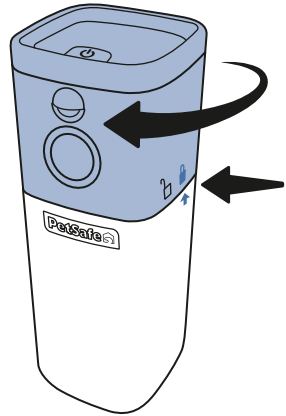

Replace the lid on the base, making sure to fit the opening on the bottom of the lid over the nozzle of the spray can.

Turn the lid clockwise to lock it.

If the batteries are running low, the power button will blink red. A solid red LED indicates that the batteries need to be replaced.

5

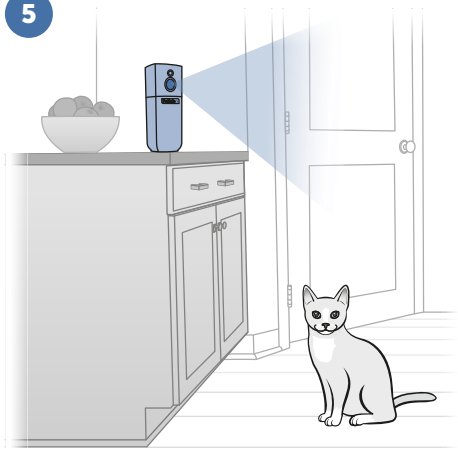

Place the spray deterrent near an area you would like your pet to avoid. The spray range is about 36 inches.

The spray deterrent uses a thermal-motion sensor that detects heat, so avoid placing in direct sunlight or near appliances that give off heat.

6

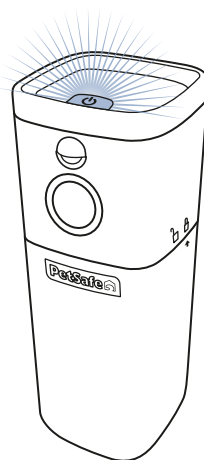

To turn the spray deterrent on, press the power button; the LED will glow green.

The spray deterrent will go through a 15-second warm-up sequence upon startup to scan the environment. Do not stand in front of the spray deterrent during the warm-up sequence.

After warm-up, the LED will flash once every 15 seconds. When the LED flashes red, it's time to replace the batteries.

Replace the can

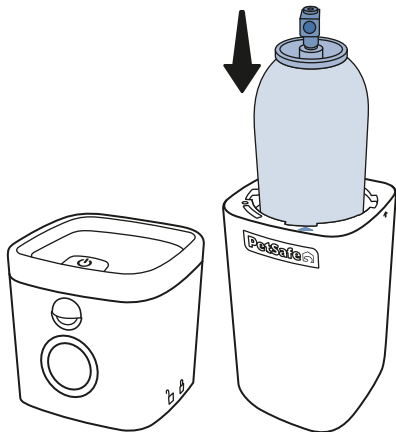

Each can will provide up to 120 sprays. When it's time to replace the can, press and hold the power button; the LED will glow red. Continue to hold the button until the LED shuts off, then release.

Unlock the lid and remove the empty can. Remove the cap from a new PetSafe® SSSCAT® Refill Can and place it in the base, turning it so the spray nozzle points to the triangle on the top edge of the base. Replace the lid and turn it clockwise to lock.

Terms of Use and Limitation of Liability

1. **Terms of Use**

The use of this product is subject to your acceptance without modification of the terms, conditions and notices contained with this product. Use of this product implies acceptance of all such terms, conditions, and notices. If you do not wish to accept these terms, conditions, and notices, please return the product, unused, in its original packaging and at your own cost and risk to the relevant Customer Care location together with proof of purchase for a full refund.

2. **Proper Use**

Proper Use includes, without limitation, reviewing the entire Product Manual and any specific safety information statements. The specific temperament or size/weight of your pet may not be suitable for this product. If you are unsure whether this product is appropriate for your pet, please consult your veterinarian or certified trainer prior to use. For products used with pets where training is desired, Radio Systems Corporation recommends that these training products are not used if your pet is aggressive and accepts no liability for determining suitability in individual cases.

3. **No Unlawful or Prohibited Use**

This product is designed for use with pets only. This product is not intended to harm, injure or provoke. Using this product in a way that is not intended could result in violation of Federal, State or local laws.

4. **Limitation of Liability**

In no event shall Radio Systems Corporation or any of its associated companies be liable for (i) any direct, indirect, punitive, incidental, special or consequential damage and/or (ii) any loss or damages whatsoever arising out of or connected with the use or misuse of this product. The Purchaser assumes all risks and liability from the use of this product to the fullest extent permissible by law.

5. **Modification of Terms and Conditions**

Radio Systems Corporation reserves the right to change the terms, conditions and notices governing this product from time to time. If such changes have been notified to you prior to your use of this product, they shall be binding on you as if incorporated herein.

6. **Limited Warranty**

This product has the benefit of a limited one-year manufacturer's warranty. Complete details of the warranty applicable to this product can be found online at <https://www.petsafe.net/support/policies-and-terms/return-and-warranty-information> and/or by contacting your local Customer Care Center at +1 (800) 732-2677, Radio Systems Corporation, 10427 PetSafe Way, Knoxville, TN 37932. Radio Systems Corporation disclaims all other express or implied warranties, including merchantability and fitness for a particular purpose.



Important Recycling Advice

Please respect the Waste Electrical and Electronic Equipment regulations in your country. This equipment must be recycled. At the end of the product life, do not place it in the normal municipal waste system. Please check the regulations in your area or return it to where it was purchased so that it can be placed in our recycling system.

Compliance

FCC

This device complies with part 15 of the FCC Rules. Operation is subject to the following two conditions: (1) This device may not cause harmful interference, and (2) this device must accept any interference received, including interference that may cause undesired operation.

NOTE: This equipment has been tested and found to comply with the limits for a Class B digital device, pursuant to part 15 of the FCC Rules. These limits are designed to provide reasonable protection against harmful interference in a residential installation. This equipment generates, uses, and can radiate radio frequency energy and, if not installed and used in accordance with the instructions, may cause harmful interference to radio communications. However, there is no guarantee that interference will not occur in a specific installation. If interference does occur to radio or television reception, which can be determined by turning the equipment off and on, the user is encouraged to try to correct the interference by one or more of the following measures:

- Reorient or relocate the receiving antenna.
- Increase the separation between the equipment and the receiver.
- Connect the equipment to an outlet on a circuit different from that to which the receiver is connected.
- Consult customer care, the dealer, or an experienced radio/TV technician for help.

CAUTION: Modification or changes to this equipment not expressly approved by Radio Systems Corporation may void the user's authority to operate the equipment.

SSSCAT[®]

Automatic Spray Pet Deterrent



We're here to help!

For questions or additional tips:
support.petsafe.com

Radio Systems Corporation
10427 PetSafe Way
Knoxville, TN 37932 USA

1-Year Limited Warranty | ©2025 Radio Systems Corporation
Models: PPD00-17617, PPD00-18209 | YU400-2690